

**Modular Cooking Range Line**  
**thermaline 85 - 800 mm Holding**  
**Cabinet with 2 drawers, GN conform, 1**  
**Side**

ITEM # \_\_\_\_\_

MODEL # \_\_\_\_\_

NAME # \_\_\_\_\_

SIS # \_\_\_\_\_

AIA # \_\_\_\_\_



**588649** Holding Cabinet with 2 drawers, one-side  
 (MB0ACAHOB0) operated, GN

### Short Form Specification

**Item No.** \_\_\_\_\_

800 mm wide holding cabinet with 2 drawers, for holding and cooking food. Internal frame for heavy duty sturdiness in stainless steel. Flat surface construction, easily cleanable. Temperature in the cabinet can be set through thermostat, up to a maximum of 120°C. Cabinet storage space accepts GN 1/1 containers, 150mm deep. IPX5 water resistant certification.

Configuration: One-side operated freestanding base.

### Main Features

- All major components may be easily accessed from the front.
- THERMODUL connection system creates a seamless work top when units are connected to each other thus avoiding soil penetrating vital components and facilitating the removal of units in case of replacement or service.
- Unit constructed according to DIN 18860\_2 with 70 mm recessed plinth.
- Temperature in the cupboard can be set through a thermostat to suit different requirements. The maximum temperature is 120°C.
- Equipped with a core temperature probe, suitable also for low temperature cooking.
- Unit can be installed below modular top appliances, designed to keep the food warm, with the capability to cook as well.

### Construction

- IPX5 water resistance certification.
- 2 mm top in 1.4301 (AISI 304).
- Flat surface construction with minimal hidden areas to easily clean all surfaces
- Storage space in the base of the appliance accepts GN1/1 containers.
- Internal frame for heavy duty sturdiness in stainless steel.

### Optional Accessories

- Stainless steel front kicking strip, 800mm width PNC 912634 ☐
- Stainless steel side kicking strip left and right, wall mounted, 850mm width PNC 912659 ☐
- Stainless steel side kicking strip left and right, back-to-back, 1700mm width PNC 912662 ☐
- Stainless steel side panel, 850x700mm, right side, against wall PNC 913003 ☐
- Stainless steel side panel, 850x700mm, left side, against wall PNC 913004 ☐
- Side reinforced panel only in combination with side shelf, for against the wall installations, right PNC 913261 ☐
- Side reinforced panel only in combination with side shelf, for against the wall installations, left PNC 913262 ☐
- Stainless steel dividing panel, 850x700mm, (it should only be used between Electrolux Professional thermaline Modular 85 and thermaline C85) PNC 913670 ☐

**APPROVAL:** \_\_\_\_\_



**Electrolux**  
PROFESSIONAL

**Modular Cooking Range Line  
thermaline 85 - 800 mm Holding Cabinet  
with 2 drawers, GN conform, 1 Side**

- Stainless steel side panel, 850x700mm, PNC 913686 ☐  
flush-fitting (it should only be used  
against the wall, against a niche and in  
between Electrolux Professional  
thermaline and ProThermetic  
appliances and external appliances -  
provided that these have at least the  
same dimensions)



**Electrolux**  
PROFESSIONAL

**Modular Cooking Range Line**  
**thermaline 85 - 800 mm Holding Cabinet**  
**with 2 drawers, GN conform, 1 Side**

Front

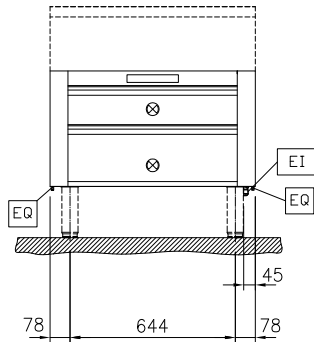

Side

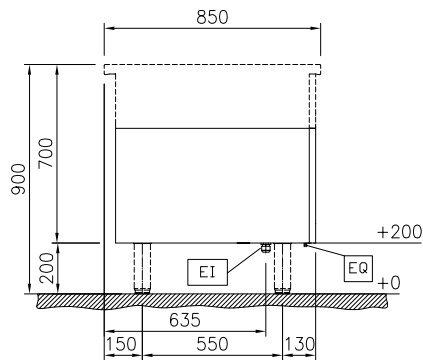

EI = Electrical inlet (power)

Top

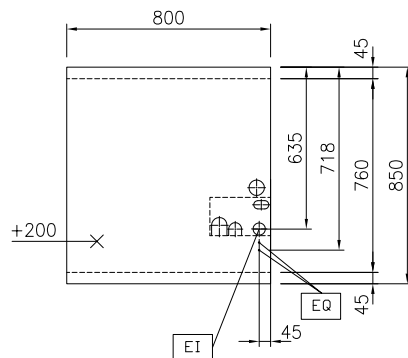

**Electric**

Supply voltage: 230 V/1N ph/50 Hz

**Key Information:**

External dimensions, Width: 800 mm  
External dimensions, Depth: 850 mm  
External dimensions, Height: 450 mm  
Cupboard Cavity Dimensions (width): 650 mm  
Cupboard Cavity Dimensions (height): 325 mm  
Cupboard Cavity Dimensions (depth): 530 mm  
Cabinet temperature range: 30-120 °C  
Net weight: 44 kg

**Sustainability**

Current consumption: 4.35 Amps



Modular Cooking Range Line  
thermaline 85 - 800 mm Holding Cabinet with 2 drawers, GN conform, 1 Side  
The company reserves the right to make modifications to the products without prior notice. All information correct at time of printing.

2025.04.18